

## IP67 Sprinter Van Brake Light Camera User Manual



## Introduction

Thank you for purchasing your EchoMaster automotive camera.

The following part numbers are supported:

- ▶ PCAM-SBL-P
- ▶ PCAM-SBL-N

EchoMaster cameras are designed to improve safety during driving by providing high quality images of surrounding areas and obstacles in the vicinity of the vehicle. They will also improve vehicle maneuvering capability by displaying blind spots not normally visible to the driver.

Please ensure you read and understand all aspects of this manual before fitting or using your EchoMaster Camera. Choose a suitable mounting place dependent on the application. Ensure that there are no wiring harnesses or hoses/pipes located behind this panel before drilling.

## Key Features

- ▶ 1/4" CMOS Sensor
- ▶ Operates at 0 LUX
- ▶ IP67 Rated
- ▶ 170 Degree Viewing Angle
- ▶ Mirrored Image

## Specifications

	PCAM-SBL-P   PCAM-SBL-N	
Sensor	1/4" CMOS	
LEDs	8	
Illumination	0 LUX	
Viewing Angle	170 degrees	
Mirror Image	YES	
Normal Image	NO	
Waterproof Class	IP67	
Audio	Yes	
Power Supply	12V DC	
Current	<150mA	
Working Temperature	-25°C - +65°C	
Dimensions (mm)	D (90) x W (330) x H (51)	
System	PAL	NTSC
TV Lines	580	480
Resolution (HxV)	762 x 504	762 x 504

## Box Contents

- ▶ Camera
- ▶ Manual
- ▶ Extension Cable
- ▶ Audio/Video Harness
- ▶ Power Harness

## Dimensions

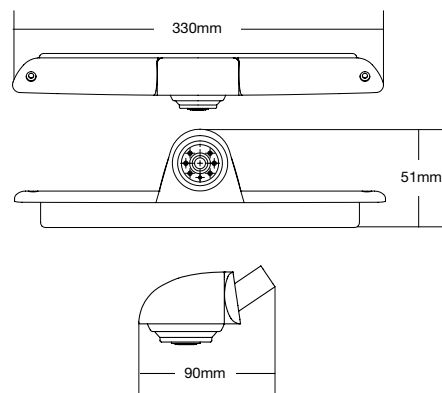

## Wiring Diagram & Pin Out



EchoMaster is a Power Brand of AAMP Global  
 EchoMaster.com  
 15600 Lightwave Drive, Suite 202  
 Clearwater, Florida 33760  
 email - support@aaampglobal.com (US)  
 email - technical.eu@aaampglobal.com (Europe)  
 AAMP  
 DEFINE YOUR DRIVE

