

PCAM-150



Lip Mount or Trunk Mount Camera with Parking Lines

User Manual



Introduction

Thank you for purchasing your EchoMaster Pro automotive camera.

This manual covers the following part numbers

- ▶ PCAM-150-P
- ▶ PCAM-150-N

EchoMaster Pro cameras are designed to improve safety during driving by providing high quality images of surrounding areas and obstacles in the vicinity of the vehicle. They will also improve vehicle maneuvering capability by displaying blind spots not normally visible to the driver.

Please ensure you read and understand all aspects of this manual before fitting or using your EchoMaster Pro Camera. Choose a suitable mounting place dependent on the application. Ensure that there are no wiring harnesses or hoses/pipes located behind this panel before drilling.

Key Features

- ▶ 1/4" CMOS Sensor
- ▶ Operates at 0.5 LUX
- ▶ 170 Degree Viewing Angle
- ▶ IP67 Water/Debris-Proof rating
- ▶ Parking Lines (selectable)

Specification

| | PCAM-150-P PCAM-150-N | |
|---------------------|--------------------------|-----------|
| Sensor Type | CMOS | |
| LEDs | 0 | |
| Illumination | 0.5 LUX | |
| Viewing Angle | 170 degrees | |
| Mirror Image | YES | |
| Normal View | Switchable | |
| Water/Debris-Proof | IP67 | |
| Audio | NO | |
| Power Supply | 9-16V | |
| Current | <50mA | |
| Working Temperature | -30C - +70C | |
| Dimensions (mm) | D (27) x W (50) x H (24) | |
| System | PAL | NTSC |
| TV Lines | N/A | 420 |
| Resolution | N/A | 648 x 488 |

Box Contents

- ▶ Camera
- ▶ RCA adapter
- ▶ Wiring Harness
- ▶ Mounting Hardware
- ▶ Manual

Dimensions

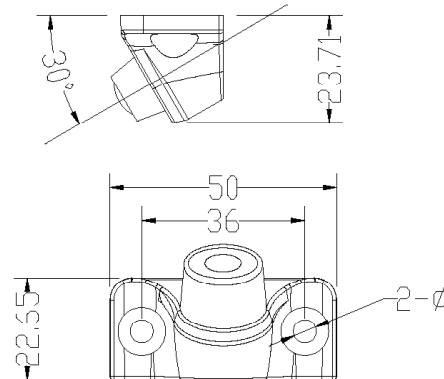

Wiring Diagram & Pin Out

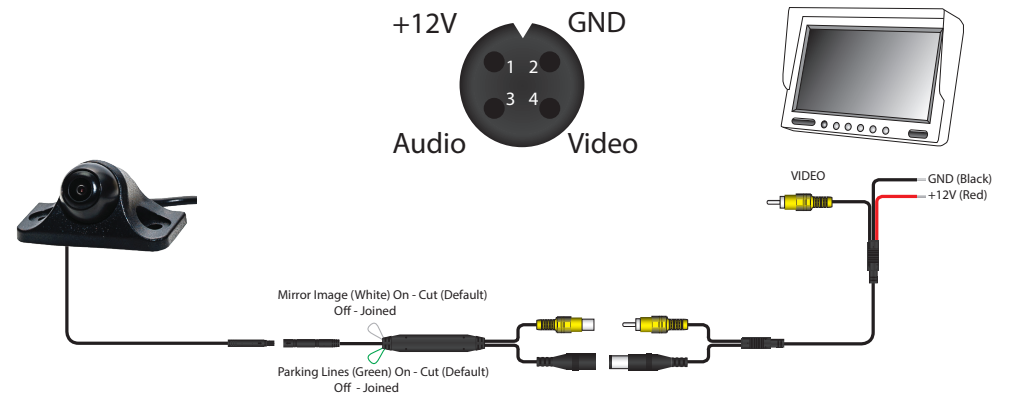

EchoMaster is a Power Brand of AAMP Global
EchoMaster.com



15500 Lightwave Drive, Suite 202
Clearwater, Florida 33760
email - support@aampglobal.com (US)
email - technical.eu@aampglobal.com (Europe)

